



Medical surface repair patch for hospital beds and stretchers
Restores damaged mattresses to an intact and hygienic state



THE PROBLEM

Damaged mattresses are common in healthcare facilities, and have been shown to harbor pathogens that contribute to Healthcare Associated Infections

Studies in Canada, US, and UK reveal that 26% to 48% of mattresses in circulation are damaged*

THE SOLUTION IS HERE . . .

PREVIOUS ALTERNATIVES

Replace Mattress	✓ Validated ✗ Unaffordable ✗ Inconvenient
Repair with Tape	✓ Inexpensive ✗ Unproven ✗ Not Durable
Do Nothing	✗ Risk Patient Safety



WHY CLEANPATCH®?

CleanPatch is the first medical surface repair patch for hospital beds and stretchers. It restores damaged mattresses to an intact and hygienic state.

Clinically Tested	<ul style="list-style-type: none">• Validated by independent Infection Prevention Professionals• Durable and impervious to fluids under rigorous conditions• Fully cleanable with hospital disinfectants
Safe and Simple	<ul style="list-style-type: none">• Early intervention reduces the risk of cross contamination from damaged mattresses• Made of latex-free, biocompatible materials• Simple peel and stick, applies in seconds
Cost Effective	<ul style="list-style-type: none">• Extends the life of mattresses and stretchers• Proactively improves patient safety• Significant savings from equipment repair versus replacement

EASY TO APPLY



1
Identify and measure damaged area.



2
Clean mattress as per hospital protocol. Let dry.

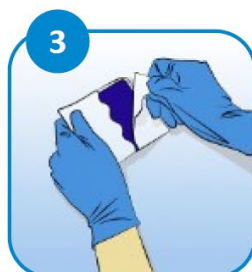

3
Remove white backing from CleanPatch.





4
Hold edges of patch and position it over the damage.



5
Apply firm pressure to the patch, especially around the edges.



6
Slowly remove the clear top liner, pulling from  to .



7
Smooth CleanPatch from center outwards. For best results wait 1 minute.



8
Clean the patch and surrounding area as per hospital protocol.

PRODUCT INFORMATION

Product Code	Clean Patch Size	Qty	Application
MP-SS30	Small 5cm circle	30/box	Damage up to 1.3cm
MP-SM20	Medium 8.8cm square	20/box	Damage up to 5cm
MP-SL10	Large 8.8 x 15cm rectangle	10/box	Damage up to 10cm

*References:

Bradbury, SL. et al. American Journal of Infection Control. 2014

Callaghan, R. Milnes, J. and Stevens, L. Wound Care Today Supplement. 2013

Creamer, E. and Humphreys, H. Journal of Hospital Infection. 2008

FDA Safety Communication, April 19, 2013

Wong, et al. University of Calgary. CleanPatch Clinical Assessment, Final report. July 2013

CLEANPatch®

Clinically Tested • Safe and Simple • Cost Effective



Visit www.cleanpatch.ca
for implementation guidelines and additional resources

Manufactured by
Surface Medical Inc.
Calgary, AB, Canada T2S 1W2
1-888-623-7085
info@surfacemedical.ca

© Surface Medical Inc. Revised Nov 2016

Distributed in SA by



SURGICAL AND MEDICAL SUPPLIES PTY LTD
16 Kensington Road Rose Park SA 5067
Telephone: (08) 8332 1666 Fax: (08) 8332 5132
Email: sales@surmed.com.au
Website: www.surmed.com.au

Contact
Chris Lee, Product Specialist
0476 777 767